

# FAST MOVER

Automotive Refinishing

## FMT1203

### Parts Storage Trolley with Panel Rack

Instruction Manual



PLEASE KEEP THIS MANUAL SAFE FOR FUTURE REFERENCE

**T:** +44 (0)1582 661993 **F:** +44 (0)1582 667100 **E:** [sales@fastmovertoolsuk.com](mailto:sales@fastmovertoolsuk.com)

# FMT1203

## Instruction Manual

### Introduction

This Parts Storage Trolley is designed to keep parts that have been taken from a vehicle safe whilst the vehicle is being repaired. The trolley also features a folding section for the storage of door panels.

### General Safety Information

- 1 Do not use this trolley whilst under the influence of drugs, alcohol and intoxicating medication.
- 2 Do not use this trolley for any other purpose other than that for which it is intended. This tool is not intended as a climbing frame or tethering point.
- 3 Do not allow children and other unauthorised persons to use this equipment.
- 4 Due to the nature of the manufacturing process, there may be some sharp edges on some components of this equipment. It is strongly recommended that hand protection is worn when using this tool.
- 5 **SWL 20kg per shelf.** Do not overload this trolley.
- 6 Always be aware of those around you and keep in mind that your actions have a direct effect on your colleagues and visitors.

### Environmental

- 1 Ensure that all packaging is disposed of in a responsible manner.
- 2 At the end of its life, this tool can be disposed of along with your normal waste, always consult local authority guidelines first.

### Dimensions

Width	1200mm
Height	1850mm
Depth	760mm (Closed)
Shelf Depth	600mm

### Parts List

Ref.	Code	Description	Qty
1	FMT1203/1	Open Mesh Shelf	3
2	FMT1203/2	3/8"x2" Screw	26
3	FMT1203/3	Long Support Tube	6
4	FMT1203/4	3/8" Washer	42
5	FMT1203/5	3/8" Nut	54
6	FMT1203/6	Wheel	6
7	FMT1203/7	Base Tube	2
8	FMT1203/8	T-Plate	10
9	FMT1203/9	Short Support Tube	2
10	FMT1203/10	Lower Cross Tube	1
11	FMT1203/11	Lower Upright	2
12	FMT1203/12	Upper Upright	2
13	FMT1203/13	Upper Cross Tube	2
14	FMT1203/14	Hook	4
15	FMT1203/15	U-Plate	8
16	FMT1203/16	Knob	8
17	FMT1203/17	Extending Arm	2
18	FMT1203/18	Support Arm and Foam	8
19	FMT1203/19	Cover	8
20	FMT1203/20	Tube	2
21	FMT1203/21	3/8"x2-1/2" Screw	4
22	FMT1203/22	3/8"x1-1/2" Screw	18

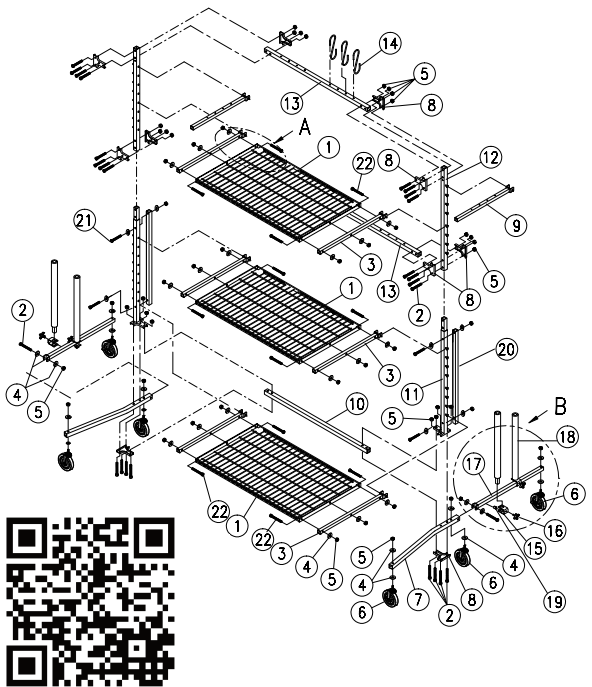

This manual can be downloaded from the web, visit [www.fastmovertoolsuk.com/FMT1203](http://www.fastmovertoolsuk.com/FMT1203), or scan the code to the right.

Fast Mover Tools Ltd

T: 01582 661993 F: 01582 667100 E: [sales@fastmovertoolsuk.com](mailto:sales@fastmovertoolsuk.com)

W: [www.fastmovertoolsuk.com](http://www.fastmovertoolsuk.com)